

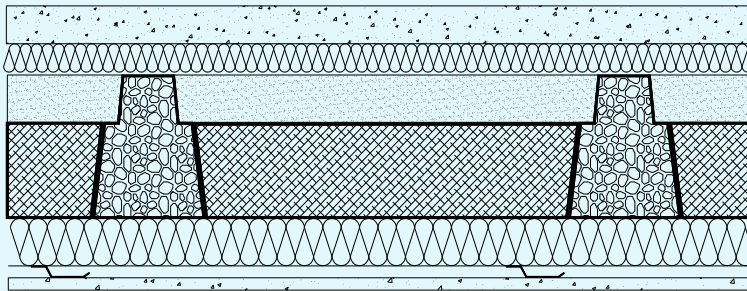

## Acoustic Test Data Sheet 07

### SEPARATING FLOOR



40mm Gyvlon levelling screed  
30mm Rockwool Rockfloor

150mm concrete beam and block floor (300kg/m<sup>2</sup>)  
50mm x 50mm timber battens at 600mm centres with  
50mm mineral wool in cavity  
12.5mm standard grade plasterboard  
on Resilient Bars set at 600mm centres

**SITE**  
**TEST ORGANISATION**  
**REPORT / TEST No. / TEST DATE**  
**TEST METHOD**  
**RESULTS**

**Laboratory**  
**Sound Research Laboratories Ltd**  
**C/03/5L/0793/1 / Tests A2 and I2 / 22nd October 2003**  
**BS EN ISO 140-4 and 7: 1998**  
**DnT,w (C ; Ctr) - 67 (-2 ; -6) dB**  
**DnT,w + Ctr - 61 dB**  
**L'nT,w (CI) - 45 (-1) dB**

#### FLOOR CONSTRUCTION

- 150mm concrete beams (34kg/m) at 600mm centres with 100mm infill blocks (1950kg/m<sup>3</sup>) laid between. Beams built into inner leaf of cavity walls at each end with insitu concrete between. Precast edge beams built into inner leaf of cavity walls at side of floor.
- 50mm sand cement screed (2300kg/m<sup>3</sup>) laid over block work between beams to finish flush with top of beams. Nominal surface mass of floor was 300kg/m<sup>2</sup>.
- 40mm Gyvlon levelling screed applied over a polyethylene slip sheet over 30mm Rockwool Rockfloor slabs with a perimeter strip of 30mm Rockwool Rockfloor.
- A ceiling comprising 12.5mm standard grade (Type 1) plasterboard fixed to resilient bars set at 600mm centres and fixed to 50mm x 50mm timber battens set at 600mm centres. 50mm mineral wool infill (16kg/m<sup>3</sup>) between timber battens.

The results show that this floor system, as tested in conjunction with the associated constructions detailed above, is able to achieve the sound insulation performance required in the Building Regulations 2000, Approved Document E, 2003 Edition.

If this floor system were to be used on site with an equivalent construction and same build quality, similar results would be expected.

#### BUILDING CONSTRUCTION DETAILS

Sound Research Laboratories Ltd. flanking transmission test laboratory at Holbrook House, Little Waldingfield, Sudbury, Suffolk. A two-storey purpose built test unit comprising 100mm brick / 50mm cavity / 100mm block (1100kg/m<sup>3</sup>) walls, a concrete beam and block first floor and a flat timber joist roof. Single rooms at ground and first floor level each approximately 25m<sup>3</sup> with a separating floor area of 10m<sup>2</sup>. 50mm Rockwool cavity closer (45kg/m<sup>3</sup>) running horizontally at the separating floor junction. Internal faces of block work finished with two layers of 12.5mm sound resistant plasterboard fixed to a 48mm independent I stud frame.

The information above must NOT be reproduced without the prior written consent of Lafarge Gyvlon Ltd Issue 2—Revision 0—01-12-10

**Lafarge Gyvlon Limited**

Unit 221 Europa Boulevard,  
Westbrook, Warrington WA5 7TN

sales@gyvlon.co.uk  
01925 428780



[www.gyvlon.co.uk](http://www.gyvlon.co.uk)



Calcium Sulfate binder  
EN 13454-CAB-30

greenspec®