

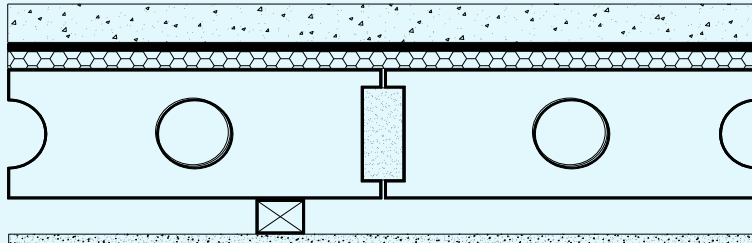

## Acoustic Test Data Sheet 18

### SEPARATING FLOOR



45mm Gyvlon levelling screed  
laid over 10mm Ethafoam on 15mm polystyrene

150mm precast concrete floor slab (300kg/m<sup>2</sup>)

12.5mm plasterboard on 50mm x 38mm timber battens

**SITE**  
**TEST ORGANISATION**  
**REPORT / TEST No. / TEST DATE**  
**TEST METHOD**  
**RESULTS**

Stevenson Street, Paisley, Scotland  
dB Acoustics and Environmental Services  
5046/03 / 5046F6 / September 2003  
BS EN ISO 140-4 and 7: 1998  
DnT,w (C ; Ctr) - 56 (-3 ; -10) dB  
DnT,w + Ctr - 46 dB  
L'nT,w (CI) - 56 (2) dB

#### FLOOR CONSTRUCTION

- 150mm precast concrete floor slab (300kg/m<sup>2</sup>)
- Joints between blocks and beams sealed with sand cement grout mix.
- 10mm Ethafoam over 15mm polystyrene
- 45mm Gyvlon levelling screed applied over a polyethylene slip-sheet with a perimeter strip of 8mm polyethylene foam.
- A ceiling comprising 12.5mm plasterboard fixed to 38mm x 50mm timber battens

The results show that this floor system, as tested in conjunction with the associated constructions detailed above, is able to achieve the sound insulation performance required in the Building Regulations 2000, Approved Document E, 2003 Edition.

If this floor system were to be used on site with an equivalent construction and same build quality, similar results would be expected.

#### BUILDING CONSTRUCTION DETAILS

##### General

Newly built block of flats comprising cavity brick/ block external walls, cavity block separating walls and precast concrete separating floors

##### External walls

102.5mm brickwork / 50mm cavity / 140mm Airtec Single FR (7N/mm) blockwork inner leaf.

Blockwork lined internally with 12.5mm plasterboard on 50mm x 25mm timber battens at 600mm centres.

##### Separating walls

275mm cavity wall comprising two leaves of 100mm dense concrete blocks (2150kg/m<sup>3</sup>) set 75mm apart.

Both sides lined with 12.5mm plasterboard on 50mm x 25mm timber battens at 600mm centres.

The information above must NOT be reproduced without the prior written consent of Lafarge Gyvlon Ltd Issue 2—Revision 0—01-12-10

**Lafarge Gyvlon Limited**

Unit 221 Europa Boulevard,  
Westbrook, Warrington WA5 7TN

sales@gyvlon.co.uk  
01925 428780



[www.gyvlon.co.uk](http://www.gyvlon.co.uk)



Calcium Sulfate binder  
EN 13454-CAB-30



greenspec®